



Hydraulic Grease Nipple Kit

Contents

Straight:

1/4" BSP,
1/8" BSP,
M8 x 1.25
1/4" BSF.

45°:

M8 x 1.25
M10 x 1.50.

90°:

1/4" BSF.

**140
PIECES**



Description	Number of Pieces	Order Code KEN-541	Price/1 TB
Grease Nipple Kit	140	-5140K	1859.00

Flexible Hoses

For use with Kennedy grease guns, flexible hoses improve access in confined spaces, 1/8" BSP connecting threads.



Bore x Length	Type	Weight each	Order Code KEN-540	Price/1 TB
150mm	Offset Metal	40g	-0390K	117.00
8x230	Nylon	30g	-0400K	158.00
8x300	Nylon	40g	-0410K	180.00
8x500	Nylon	40g	-0420K	220.00
11x230	Rubber	60g	-0430K	256.00
11x300	Rubber	70g	-0440K	267.00
11x500	Rubber	90g	-0450K	337.00

Magnetic Pick-Up Tools

Slimline Handle

Telescopic with magnetic tip and contoured handle

Extended Length (mm)	Weight each	Order Code KEN-553	Price/1 TB
550 (22")	50g	-0100K	427.00

Pen Type Handle

Telescopic with magnetic tip and pen type handle with pocket clip

Extended Length (mm)	Weight each	Order Code KEN-553	Price/1 TB
650 (26")	40g	-0120K	129.00

Multi-directional Head

Magnetic tipped multi-directional head and pen type handle

Extended Length (mm)	Weight each	Order Code KEN-553	Price/1 TB
580 (23")	46g	-0140K	273.00

Flexible Shaft

Magnetic tipped with full adjustable shaft and weighted handle

Extended Length (mm)	Weight each	Order Code KEN-553	Price/1 TB
455 (18")	96g	-0130K	659.00

Hydraulic Grease Nipples

For use with Kennedy grease guns and all other hydraulic grease equipment.



Straight Hook-On

Thread Size	Weight Per 100	Order Code KEN-541	Price/1 TB
1/8" BSP(T)	1.30kg	-1070K	60.00
1/4" BSP(T)	2.00kg	-1090K	67.00

45° Type



Thread Size	Weight Per 100	Order Code KEN-541	Price/1 TB
1/8" BSP(T)	1.30kg	-0610K	42.00
1/4" BSP(T)	1.95kg	-0690K	76.00
1/4" BSF	0.70kg	-0770K	62.00
M6 x 1	0.70kg	-0850K	42.00
M8 x 1.25	0.60kg	-0930K	46.00
M10 x 1.5	1.25kg	-1010K	47.00

Straight Type

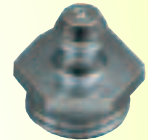

Thread Size	Weight Per 100	Order Code KEN-541	Price/1 TB
1/8" BSP(T)	0.60kg	-0600K	21.00
1/4" BSP(T)	1.10kg	-0680K	30.00
1/4" BSF	0.30kg	-0760K	26.00
M6 x 1	0.30kg	-0840K	21.00
M8 x 1.25	0.50kg	-0920K	21.00
M10 x 1.5	0.60kg	-1000K	26.00

90° Type

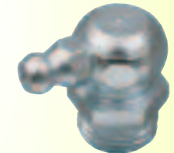

Thread Size	Weight Per 100	Order Code KEN-541	Price/1 TB
1/8" BSP(T)	1.30kg	-0630K	42.00
1/4" BSP(T)	2.10kg	-0710K	92.00
1/4" BSF	0.70kg	-0790K	56.00
M6 x 1	0.60kg	-0870K	50.00
M8 x 1.25	0.55kg	-0950K	47.00
M10 x 1.5	1.30kg	-1030K	56.00

Hydraulic Connectors

Securely grips the grease nipple while in use.

4-Jaw

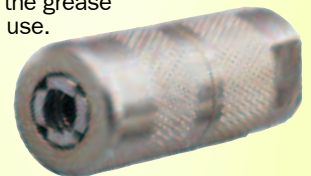

Thread Size	Weight each	Order Code KEN-541	Price/1 TB
1/8" BSP(T)	40g	-0480K	147.00

Hook-On

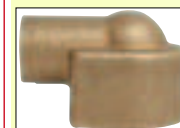

Thread Size	Weight each	Order Code KEN-541	Price/1 TB
1/8" BSP(T)	40g	-0490K	252.00

HAND TOOLS



Magnetic Trays

For holding metal items such as nuts, bolts, washers etc.

Dish

For use in high and confined spaces with rubberised magnetic base mat to protect work surface.



Size (mm)	Weight each	Order Code	Price/1 TB
150 dia.	375g	-0250K	509.00

Rectangular Tray

For holding larger items.



Size (mm)	Weight each	Order Code	Price/1 TB
242 x 142	720g	-0300K	882.00

Magnetic Parts Tray

Rustproof stainless steel tray fitted with 4 x 85mm magnets in a non-marking cover which attaches to any ferrous surface. For retaining hand tools and fasteners, ideal for applications where nuts, bolts and parts could get lost preventing assembly. Suitable for automotive mechanics, appliance repairs and most applications within the service and repair industry.

Size: 295 x 270 x 42mm.



Bottom of tray

Size (mm)	Weight each	Order Code	Price/1 TB
295 x 270 x 42	1.60kg	-0270K	1569.00



Magnetic Vee Block

Ideal for holding cylindrical workpieces for grinding application. The adhesion will simultaneously hold the workpiece and vee-block to any flat ferrous surface.

Dimensions (W x L x H):
70 x 102 x 95mm.



Magnetic Adhesion	Weight each	Order Code	Price/1 TB
50kgf	4.00kg	-1100K	23339.00

Magnetic Link

Two magnetic units joined by an adjustable steel strap (82mm long). Capable of holding at many different angles.

Single link base dimensions (L x H x W):
60 x 30 x 25mm.

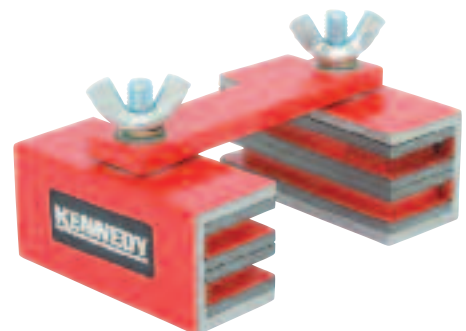

Magnetic Adhesion	Weight each	Order Code	Price/1 TB
13kgf	350g	-1400K	2806.00

Magnetic Holder

Incorporates vee and plain faces. Enables accurate positioning of workpieces relative to each other, also secures sheets, bars and tubes.

Dimension (W x L x H):
108 x 108 x 104mm.



Magnetic Adhesion	Weight each	Order Code	Price/1 TB
100kgf	6.00kg	-1300K	28433.00



Magnetic Pick-Up Tool

High power magnet for easy pick-up and release of metal objects. Can be used for scrap and ferrous debris. Spring-loaded magnet release. Permanent magnet, never needs to be re-magnetised.



Working Size	Weight each	Order Code	Price/1 TB
100mm dia.	634g	-0160K	592.00

Magnetic Long Reach

Long reach handle. High power magnet for easy pick-up and release of metal objects. Can be used for scrap and ferrous debris. Spring-loaded magnet release. Permanent magnet, never needs to be re-magnetised.

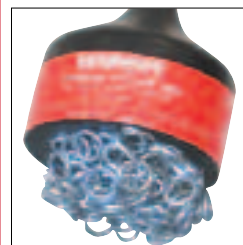

Working Size	Weight each	Order Code	Price/1 TB
90mm Dia.	693g	-0180K	776.00

Magnet Extending Pick-Up Sweeper

High power magnet for easy pick-up and release of metal objects. Can be used for scrap and ferrous debris.



Permanent magnet, never needs to be re-magnetised. Lightweight. Chrome-plated and corrosion-resistant.

Working Length	Weight each	Order Code	Price/1 TB
140cm	1430g	-0220K	2426.00

Magnetic Pick-Up Wand

High power magnet for easy pick-up and release of metal objects. Can be used for scrap and ferrous debris. Permanent magnet, never needs to be re-magnetised. Lightweight. Chrome-plated and corrosion-resistant.



Working Length	Weight each	Order Code	Price/1 TB
140mm	567g	-0200K	2014.00

HAND TOOLS

GROUP 553 MAGNETIC TOOLING

KENNEDY Magnetic Hold Fast

Positive gripping pot magnets supplied with screw-down release handle. Can be used singly or in multiples for making welding or other jigs. With M8 x 1.25 thread. **Depth:** 35mm.



Diameter (mm)	Magnetic Adhesion	Weight each	Order Code KEN-554	Price/1 TB
40	20kgf	590g	-1200K	3263.00
50	40kgf	955g	-1240K	4521.00

Magnetic Quick Clamp

For fast accurate holding.

Dimensions: (width x length x thickness): 65 x 110 x 15mm.



Angles	Weight each	Order Code KEN-554	Price/1 TB
30°, 90° & 135°	270g	-1700K	539.00

Channel Magnet

Designed to give maximum grip within channels or slots. Able to grip non-uniform workpieces.



Length x Width x Height (mm)	Weight each	Order Code KEN-554	Price/1 TB
130 x 30 x 13	250g	-3500K	1550.00

Power Magnets

A square horseshoe magnet. Supplied with plain fixing holes.

Kg pull (max):
25mm - 4.5,
30mm - 9.0,
40mm - 11.8.



Size (mm)	Weight each	Order Code KEN-553	Price/1 TB
25 x 40 x 20	60g	-8120K	1204.00
30 x 45 x 30	120g	-8130K	1663.00
40.5 x 57 x 35	180g	-8140K	2315.00

Ferrite Shallow Pot Magnets

Manufactured from ceramic ferrite material set in a mild steel shell. Suitable for holding machine tool accessories with M6 threads or building into jigs.

Heavy Duty L-bolt



Ø x Width (mm)	Weight each	Order Code KEN-553	Price/1 TB
66 x 10.7	220g	-7020K	881.00
76 x 12.5	300g	-7040K	984.00
100 x 15.5	610g	-7060K	2575.00

J-bolt



Size (mm)	Weight each	Order Code KEN-553	Price/1 TB
46 x 10.7	90g	-8900K	378.00
56 x 10.7	130g	-8910K	413.00
66 x 10.7	190g	-8920K	420.00

Magnetic Chuck Blocks

For use with magnetic chucks that have parallel poles, so that the magnetic field can be extended to hold awkwardly shaped workpieces. Supplied in matched pairs. Machinable.

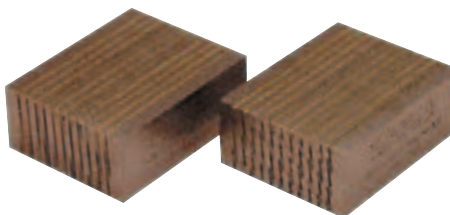

Width x Length x Height (mm)	Weight each	Order Code KEN-400	Price/Pr TB
60 x 75 x 30	1.50kg	-2500K	2500.00

Bar Magnets

A range of one-piece cylindrical magnets with opposing poles at either end. Permanently magnetic.



Dia. (mm)	Depth (mm)	Weight Per 100	Order Code KEN-553	Price/1 TB
6.0	20 (3/4")	0.44kg	-8050K	187.00
8.0	25 (1")	1.00kg	-8060K	274.00
10.0	30 (1 3/16")	1.90kg	-8070K	174.00

Button Magnets

A horseshoe type cylindrical magnet. Opposing poles are at the same end of the magnet separated by a slot. Supplied with a plain bore and keeper. Permanently magnetic.



Diameter (mm)	Depth (mm)	Weight Per 100	Order Code KEN-553	Price/1 TB
12.7 (1/2")	9.5	0.87kg	-8210K	197.00
20 (3/4")	12.5	2.00kg	-8220K	338.00
25 (1")	16.0	5.60kg	-8230K	457.00
32 (1 1/4")	19.5	13.0kg	-8240K	782.00

Shallow Pot Magnets

North polarity in centre separated from opposing pole by a continuous slot. For use in areas of restricted height. Supplied with plain bore fixing hole and keeper. Permanently magnetic.



Diameter (mm)	Depth (mm)	Weight Per 100	Order Code KEN-553	Price/1 TB
20 (3/4")	7.8	1.75kg	-8260K	363.00
28.5 (1 1/8")	8.7	4.70kg	-8270K	479.00
38 (1 1/2")	10.6	9.70kg	-8280K	808.00

Deep Pot Magnets

North polarity in centre separated from opposing pole by a continuous slot. Ideally suited for gripping applications. Supplied with M5 x 1 threaded bore fixing hole and keeper. *M3 x 0.5.



Diameter (mm)	Depth (mm)	Weight Per 100	Order Code KEN-553	Price/1 TB
9.5 (3/8")*	15.1	2.00kg	-8290K	131.00
17.5 (11/16")	16.0	2.70kg	-8310K	157.00
20 (3/4")	18.0	4.50kg	-8320K	418.00
27 (1 1/16")	25.4	9.80kg	-8330K	457.00
35 (1 3/8")	30.0	28.9kg	-8340K	764.00

Set

2 each: 12.7mm button.
1 each: 17.5mm deep button,
20mm button and 20mm pot.

5 PIECES



Number of Pieces	Weight each	Order Code KEN-553	Price/1 TB
5	90g	-9000K	708.00

HAND TOOLS